

ECL



File

10 DOWNING STREET

THE PRIME MINISTER

4 October 1984

Dear Sir Leslie,

May I thank you warmly for welcoming Patrick Jenkin and myself to the International Garden Festival and to the Albert Dock. The achievements of the Merseyside Development Corporation under your Chairmanship have been immense. You can justly take pride in the tangible results of the past 3½ years.

The International Garden Festival was not only a delight to visit but an enormously heartening example of what can be done to tackle the problem of urban decay.

I found the Albert Dock a most impressive project which, when completed, will provide the centre of Liverpool with a most valuable asset.

I am grateful to you for all you have done in your time as Chairman and I wish the Corporation well, under its new Chairman, Donald Forster.

Yours sincerely
Margaret Thatcher

Sir Leslie Young, CBE, DL.

WPO



10 DOWNING STREET

THE PRIME MINISTER

8 October 1984

Dear Mr. Eppel.

I was most grateful to you for showing me round the Albert Dock. It is a magnificent project and the transformation that Arrowcroft Investments are helping to bring about will provide a great source of encouragement to the City of Liverpool.

Yours sincerely
Margaret Thatcher

Leonard Eppel, Esq.,

JL

Mr Epper is Chairman
of Aircraft Investments
who are developing Albert
Dock



Parker Bauer Publishing Limited

SPECIALISTS IN CLUB AND BUSINESS DIARIES
CONSULTANTS IN DESIGN

4 Berwyn Drive, Heswall, Wirral, Merseyside L61 6UD Telephone: 051-342 6883

The R.H. Margaret Thatcher, M.P.,
Prime Minister,
10 Downing Street,
LONDON.

Our Ref:

Your Ref:

Date: 15 October 1984.

Dear Mrs. Thatcher,

Following your recent visit to the International Garden Festival in Liverpool, we, as publishers of the Official Souvenir Diary, would ask you to accept the enclosed copy as a small memento of your trip to Merseyside.

We remain

Yours sincerely,
PARKER BAUER PUBLISHING LTD.

Linda Bauer (Mrs).
Director.

GR
Re through
18/10
17/10

Enc.



Merseyside Development Corporation

Royal Liver Building Pier Head Liverpool L3 1JH Telephone (061) 236 6090 Telex MDC 627110 CHACOMG

LCY/DA

8th October, 1984

Prime Minister:

The Rt.Hon. Margaret Thatcher, P.C., M.P.,
The Prime Minister,
10 Downing Street,
London.

Jon Peter

must have crossed out

sr letters.

Dear Prime Minister,

I cannot let the occasion of your visit to the International Garden Festival and to the Albert Dock complex pass without writing to say how much we of the Merseyside Development Corporation enjoyed and were stimulated by it.

Dr
9/10

Here in Merseyside you were able to experience for yourself the warmth of feeling and support for you and your policies - an aspect of Liverpool life not often publicised - and by coming you demonstrated your own concern for the problems of the City.

Thank you also for the very kind remarks you made at lunch in the United Kingdom Government Pavilion about the work of the Merseyside Development Corporation and my own role in it. I did not reply at the time as you had indicated that it was not an occasion for speeches. However, I would like to express my sincere appreciation in this letter.

May I close by wishing you success in everything you are doing, which I fully support.

Yours sincerely,

Leslie Young

Sir Leslie Young, CBE, DL

Chairman - ~~Leslie Young~~ CBE; Deputy Chairman - Sir Kenneth Thompson Bt;
Chief Executive - Basil Bean; Commercial Director - Alex Anderson;
Director of Development - John Ritchie; Director of Finance - David Morse

International Garden Festival Liverpool '84



Page

Andrew



10 DOWNING STREET

PM's comments on picture of
International Festival Garden

- Mike Fawcett (DOE
Manchester) confirms
that BBC Radio
Merseyside interview is
accurate.

SW.

BB

BBC RADIO MERSEYSIDE - 20/1

Interviewer: Well yesterday the North West Tourist Board called on the Govt for £10m to ensure that the site would be kept in a reasonable state after the Festival closes. What chance and what hope have you got of that request being granted?

PM : Well I wouldn't say that £10m was the only way in which it could be kept going. I think it's done a marvellous job. We've paid a great deal of money to have the land reclaimed. Quite right it needed to be reclaimed to give Liverpool a future. The use to which it's been put has been marvellous. I know that it closes in about a fortnight. I and a number of other people are deeply concerned about its future - I can't just decide here and now - it has to be in consultation ~~with~~ between many many people. I think this has done fantastic things for L'pool and I hope that in some way the site will be able to do so many more things.

Liverpool, V:sk



File

2 MARSHAM STREET
LONDON SW1P 3EB
01-212 3434
My ref:

Your ref:

4 October 1984

Dear Andrew

PRIME MINISTER'S VISIT TO LIVERPOOL ON
2 OCTOBER

I enclose a copy of a note from the Merseyside Task Force which is I think self-explanatory.

You will however wish to consider whether the letter at Annex A should be sent to Councillor Hamilton as the MTF suggest. If you judge that a letter would be appropriate I would advise the deletion of the last sentence of the draft.

I doubt whether the draft at Annex A is suitable for the names at Annex B (2). I would therefore suggest a further draft letter to Lord Aberconway, Donald Forster, Leonard Epple, Barry Marsh, and Basil Bean at Annex G and a separate letter to the two Bishops at Annex H.

Your sincerely

John Ballard

JOHN BALLARD
Private Secretary

Andrew Turnbull Esq

2 of 11

cc Mr. Renshaw
Mr. Morrison

PS/Secretary of State

Prime Minister's Visit to Liverpool on 2/10/84

As requested by No. 10 I attach draft letters which the Prime Minister may wish to send to those to whom she was introduced during the course of her visit to Liverpool on 2 October.

The letter at Annex A has been drafted in general terms and could be sent to the majority of those concerned - names and addresses at Annex B. I have only included the main personalities who were introduced at each point during the course of the day eg Councillor John Hamilton, Leader of Liverpool City Council, and not all members of his delegation.

A separate letter is called for when writing to the individual exhibitors at the Wavertree Tech Shop Exhibition. It would seem appropriate for the Prime Minister to write to the Head of the Companies concerned rather than those running the stalls. A draft is at Annex C and a list of names and addresses at Annex D.

No doubt the Prime Minister will want to write in more specific terms to Sir John Clark and Sir Leslie Young in view of their special roles at Wavertree and the IGF/Albert Dock respectively. Draft letter to Sir John is at Annex E and to Sir Leslie at Annex F.

R. K. Madders

R. K. Madders
Merseyside Task Force
4 October 1984

DRAFT LETTER FOR THE PRIME MINISTER TO SEND TO SIR LESLIE YOUNG

It was kind of you to show me round the International Garden Festival site and the Albert Dock development during the course of my visit to Liverpool on 2 October. Both developments show in different ways what can be achieved on Merseyside with good leadership and management.

I was glad that we were able to meet over luncheon, when I visited the International Garden Festival on 2 October. The Festival itself is a fine example of what can be achieved on Merseyside with good management and leadership; it is a tribute to all concerned and let us hope an example to be followed widely.

CKS STRIKE

This was modified
after Messrs Doherty
(Haber Bowd Clowrie
directed to PM's
reference at Waverley
but Liverpool was first
last back

File a
Liverpool visit

Called by Union 1 pm 24 August. AT

Several ports including Liverpool stopped work that afternoon.

TURN TO WORK

Department of Transport advise that Liverpool was one of the first
not one of last back.

Recommended by Union 1.30pm 18 September.

Liverpool one of the first back working by 5.30pm 18 September
without a vote.

Some North East ports went back only after a vote on following
day.

Others, principally, Bristol and London were out for several more
days as local issues confused the national return.

Liverpool ECHO



Outlook: Rain, sunny spells.
Noon: 10.9C (51.6F)
Y'day: 11.6C (52.9F)



32,480

TUESDAY, OCTOBER 2, 1984

14p

The paper that speaks up for Merseyside

IT'S HOLIDAY WEEK IN YOUR ECHO!

HOLIDAYS IN NEW YORK & PARIS

TO BE WON—P.10



PAT PHOENIX
Her new life —P.6

THE OLDER WOMAN and the YOUNGER MAN
WOMAN Page 8

£100,000 ECHO LINE-UP

IS ON PAGE 19

14p
Best value around

People * Politics * Television * News * Sports

Hush-hush city tour starts with surprise caller at breakfast

GIZZA HOUSE

MAGGIE!

Catherine, 62, gives the Premier taste of life in rundown tenement

A TEARFUL pensioner took the Prime Minister into her slum flat today and pleaded: "Please get me a house."

Mrs. Catherine Langton (62), took Mrs. Thatcher on a tour of her rotting Toxteth tenement. Then she said goodbye with a kiss on the Premier's cheek.

The Prime Minister and Mrs. Langton came face-to-face as Mrs. Thatcher encountered one of the few demonstrators on her hush-hush tour of Liverpool.

Mrs. Veronica Hoase, of Langley Way, Toxteth, shouted at the Premier to inspect the appalling housing conditions in the area.

Then Mrs. Langton stepped in. She told the unruffled Premier: "I'll stand by you. No one will touch you while I'm here."

Mrs. Langton, who has been on the housing waiting list for years, took Mrs. Thatcher into her Prince William Street flat.

She was spared no detail — and even shown the blocked toilet.

Echo reporting team: Peter Phelps, Tim Rogers and Andrew Edwards.

Echo photographic team: John Davidson, Derek Wright, Richard Williams.

A word in your ear . . . Mrs. Catherine Langton leads the Prime Minister into her home to show her the "appalling living conditions." She asked Mrs. Thatcher to help find her another home.

One man shouted to her from a first floor window: "Go inside the blocks — see the rats." She shouted back: "I've been inside".

Derelict

As the motorcade passed Joliffe Street, the Toxteth Wimpey "dream home" development taken over by the council, Mrs. Thatcher stopped to see the property which has already burned out.

Then it was on for a glimpse of the Anglican Cathedral precinct scheme from the top of the site office before calling in at the Barratt Minster Court development, where derelict flats have been turned into luxury homes.

There she found resigned
Continued on Page 3



Face-to-face with the heroin evil

A SHOCKED Mrs. Thatcher came face-to-face with Liverpool's drug problem today.

The Prime Minister paid a surprise visit to a Toxteth youth centre as part of her hush-hush city housing trip.

And there, against a background of blaring pop music, five unemployed youngsters told her they were converting the building to provide a refuge for drug addicts.

"So many people we know are on heroin," 26-years-old David Osu told her. "On heroin?" a

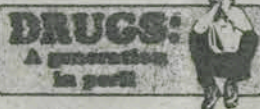

- Echo takes drugs campaign to Labour conference — Page Two.
- Drugs in jail — Page Three.

shaken Mrs. Thatcher said in almost a whisper. Then she declared: "It's terrible. If we can find the people who are peddling it, they should have really stiff penalties."



HIGHLIGHTS

FOR 4 WEEKS ONLY

£9.99
ING WASH & BLOW
PLUS FREE VENT BRUSH (LIMITING EXTRA)

GT. CHARLOTTE STREET, L1
Tel.: 051-709 3165
Blacklers 1st Floor, 709 3166



Kinnock speaks up on violence

LABOUR leader Neil Kinnock this afternoon attacked picket line violence by both police and miners. His speech to the Party conference in Blackpool brought him into direct confrontation with miners' leader Arthur Scargill.
Conference Report—
Page 2

Wearisome Willy and dozy Harry!

PRINCE Harry is a sound sleeper and never disturbs his parents at night, Prince Charles said today

The Prince, on his first engagement since his second son was born a fortnight ago, was bombarded with questions about the baby, but he also had a word about two-year-old Prince William. He told a nursery nurse: "I'd give you an hour with my child and you'd be worn out."

Full Story—
Page 5

My way right for city

Maggie

A REVIVAL in Liverpool's fortunes depends on "painful adjustment", Prime Minister Mrs. Margaret Thatcher said in the city today.

'Clanger' angers docks bosses

MRS. THATCHER dropped a clanger in Liverpool today — and infuriated Mersey docks bosses.

The Prime Minister had said she was "deeply disappointed" to hear Liverpool dockers were the first out and the last back in the latest docks strike.

But today Docks Company bosses said she was wrong and that Hull was the first out and Liverpool was among the first back.

Mrs. Thatcher was speaking in the city about Liverpool making a recovery when she referred to the strike and said she had hoped the Liverpool dockers would seize the opportunity to continue the recovery and resist the action.

"I was deeply disappointed that they were the first out and the last back to work," she said.

'Gizza house'

From Page One

dents David Connolly, conductor of the Birkenhead Operatic Society, hard at work completing a musical score for tonight's dress rehearsal of a show song reviews.

She was clearly impressed by his diligence and told him: "You are a rare person".

Earlier the Prime Minister was a surprise breakfast-time visitor at the Toxteth home of Joe and Rose Murphy.

Mr. Murphy said: "She took us by surprise. We had no idea she would want to have a look round our home."

"She asked us how long we had lived here and she seemed very impressed by it all."

An R.A.F. Andover of the Queen's Flight flew the Prime Minister and Environment Secretary Patrick Jenkin into Liverpool Airport just after 9.30 amid security reminiscent of a Royal visit.

They were met by a five-car motorcade, with a strong police escort, and whisked away ignoring red traffic lights for a drive through the depressed inner-urban areas of Speke and Dingle.

Compliment

The first top was the new Grafton Crescent housing cooperative where Mrs Thatcher stepped out of her black Daimler and immediately met startled eight-year-old Jenny Ryan. "You are a tall girl for your age," she told the speechless youngster.

Residents, rehoused in February from Caryl Street tenements to the scheme they pioneered themselves knew a VIP was coming but were not told it would be Mrs Thatcher until early today.

Mrs. Thatcher, wearing a grey winter coat, matching shoes, a pearl necklace and earrings, talked to a group of residents who had come out

to watch her arrival.

Mrs. Patty Pritchard said: "She thought the houses were lovely, and complimented us on their design and condition."

"She seemed to be very nice, and wanted to know everything about the estate that we could tell her. I'm not saying if I support her or not, but you have to be hospitable, don't you."

Security

Mrs. May Foster (71), was anxious to show the Prime Minister around her home.

"I don't bother much with politics in fact I don't vote at all, but it was nice to see her here and I'm very pleased she came to look at my home. She was very polite and I was impressed by her," said Mrs. Foster.

Mrs Thatcher's verdict on the house: "It just shows what can be done with a certain amount of money."

The Premier's visit—her first to the city since the aftermath of the Toxteth riots—was planned at the last minute to coincide with Mr. Jenkin's pre-arranged tour.

This afternoon the Prime Minister was visiting the new Albert Dock development, accompanied by Mr. Jenkin, before moving on to Huyton for a Conservative party engagement.

Speaking at the launching of Wavertree Technology Park, Mrs. Thatcher admitted Liverpool's problems were acute.

But she insisted her Government's spending policies, particularly concerning local government expenditure, would, in the long run, serve to make life better on Merseyside.

She said the key to Liverpool's revitalisation was a working partnership between private enterprise and the public sector. And, she maintained, her way was the right way to achieve that goal.

"High Government spending and ambitious public sector programmes lead inevitably to high taxes, high inflation and high interest rates, all of which will destroy jobs," she said.

Painful

Mrs. Thatcher said Liverpool had to make painful adjustments for the future.

But she said the Government was committed to helping Liverpool. The resources available to Merseyside were substantial, she said.

"They are not merely financial, nor are they the monopoly of the public sector," she said.

The Government had done its part, investing over £120,000,000 in the inner-city partnership programme.

It had also established the Merseyside Development Corporation, an enterprise zone at Speke, a freeport and 17,000 places in Merseyside under the Youth Training Scheme.

She admitted Liverpool faced grave housing problems, but said the emphasis needed to be more on maintaining and overhauling existing buildings, rather than demolishing, then building new homes.

On the Wavertree Technology Park, she said the development, built from private and public money, was a perfect example of what can be done on Merseyside.



A cheery Mrs. Thatcher makes a point during her speech today.



Mrs. Thatcher and Christine Oruche share a laugh at Minster Court.



Pointing the way... Mrs. Thatcher sees the funny side while chatting to residents of Grafton Walk, Toxteth.

Garden site
may go up for grabs

LIVERPOOL'S International Garden Festival site is likely to become a leisure park run by private enterprise.

Mr. Patrick Jenkin, Secretary of State for the Environment, said it was one of the options. He ruled out the Government aid sought by Liverpool City Council to help maintain the festival hall, other buildings and parkland.

Speaking before visiting the festival today, he said the site owners, Merseyside Development Corporation, would need to look to private enterprise if the council decided to go back on their agreement to take over the area when the festival closes later this month.

Problem

"The problem is that if the M.D.C. had to run it, it would be at the expense of other projects," he said. "There is no way I can conjure money out of the air in order to meet any costs."

"Liverpool has got its park, festival hall, theatre, pub, asplanade, all sorts of things. All they are being asked to do now is to run it."

"The idea that the taxpayer should help still further is one which would be extremely difficult to sell elsewhere."

Mr. Jenkin said it would be ironic if a decision by a council of the political complexion of Liverpool produced a privatised leisure area operating at a profit.

But, he added, the Labour council still had two months or so to pick up the undertaking by the previous Liberal administration in the knowledge that there could not be any specific Government finance.

Drugs the key to prisoners' power in jail

TRADING power by prisoners now centres around possession of drugs, it was claimed today.

Traditional "tobacco barons" are turning to drug peddling, says a national report by the Prison Officers' Association.

Liverpool's Walton Jail is high on the list of drug discoveries—including heroin, LSD and morphine.

Searches

Prison officers are now pressing the Home Office for better drug search training to help combat the increase in trafficking inside jails.

The report says there was almost one

drug seizure a week at Walton during 1982 and 1983.

The problem has escalated so much that prison visitors are sometimes searched before meeting inmates. Visiting is the main method of smuggling drugs inside.

Mr. John McDonnell, secretary of the Liverpool branch of the P.O.A., said: "It is an increasing problem. Traditionally tobacco has always been the main form of trade inside jails, but now it is fair to say that drugs are running alongside that as buying power".

Mr. John Richardson, prison governor at Walton, was not available for comment.

Stock Market

ANOTHER slide on Wall Street overnight and the Bank of England's gloomy economic forecast yesterday made for a drab opening on Northern Markets.

Top industrials were widely lower with losses stretching into the twenties. British Funds, however had so far managed to hold reasonably steady as the pound strengthened slightly against the dollar.

The F.T. Index at 1 p.m. was 851.3, down 5.6.

Television * News * Sports

2 of 2.

and sit-in rebels

QUAD T TO ORM S RIG

staging an occupation at Cammell were arrested today as police 13-week sit-in. special police squad was planning an gas rig.

By Alan Quantrough

moment is that there is an enormous police presence," said boilermakers' union leader Barry Williams.

"We think a move by the police is now imminent."

The move followed the expiry of a court deadline at midnight, ordering the men to abandon their action or face a month in jail for contempt of court.

The men were trapped in a well-planned police manoeuvre as they fled the navy vessel Edinburg and tried to dash

to the gas accommodation rig.

Six men were cornered near the main gates of the yard. As they waited three police vans led by Chief Superintendent Richard Adams drove from behind sheds to make the arrests.

As police approached some of the men fell and refused to move but were quickly bundled away.

All the men were taken to Mortimer Street police station, less than half a mile from the yard.

Continued on Page 3

Maggie for Merseyside



Margaret Thatcher

By Peter Fledge Local Government correspondent

THE Prime Minister is planning a surprise visit to Liverpool tomorrow.

Speculation was mounting today that Mrs Thatcher would accompany her Environment Secretary Patrick Jenkin on a trip to the Albert Dock Village complex and, possibly, to the garden festival.

But any appearance by Mrs Thatcher in Liverpool is bound to be shrouded in secrecy.

No official sources would confirm or deny the report.

The Central Office of Information which handles ministerial visits referred inquiries to the No 10 Downing Street Press office, where a spokesman said: "We never disclose Mrs Thatcher's diary in advance. It's a matter of strict policy."

Criticised

But Mr Jenkin's movements are usually revealed in advance and the C.O.I. was maintaining a curious silence about tomorrow's visit.

A visit by Mrs Thatcher would be bound to cause controversy in Labour-dominated Merseyside.

But it was said that the Prime Minister would attend the International Garden Festival at some stage and the week of the Labour Party conference in Blackpool, when most Labour leaders are away, would seem an opportune time.

Mrs Thatcher has not been to Liverpool since the Toxteth riots in 1981

Labour's away at the seaside as the contest is clear for Premier

Parliamentary

Ballard N 16/05

Rk

THE LABOUR PARTY CONFERENCE

ANDY GRICE

Scargill wins ovation

THE Labour Party Conference today gave a standing ovation to the miner's leader Arthur Scargill after he claimed his union was challenging "the whole basic concept of the Tory Government's philosophy."

Mr Scargill said: "There are no uneconomic pits. There are only pits which have been deliberately starved of investment."

Conference report - Page 2

OBJECTIVES OF THE VISIT

ms

To give the Prime Minister the opportunity to see at first hand

i) the problems of run down housing, poor environment and the effects of a declining economy in inner Liverpool;

ii) some of the initiatives being implemented under the Urban, Housing and Derelict Land Programmes - many in collaboration with the private sector - to tackle these problems; and

iii) to fulfill her promise? that she would visit the International Garden Festival before it closes and see some of the other projects being sponsored by the Merseyside Development Corporation /especially the Albert Dock refurbishment7.

The PM will wish to publicly reiterate the Government's commitment to tackle the problems of the older urban areas and emphasise the central importance of working in collaboration with the private sector.

LIVERPOOL

INTRODUCTORY BRIEF

In the past 25 years Liverpool has lost about 30% of its population. Unemployment has risen from 3% to almost 19% over the same period. This despite extensive Government support over a number of years (£1 billion in each of the past 3 years has been spent on Merseyside as a whole - Annex A).

HOUSING

Considerable parts of the city display poor housing conditions, high level of social stress and poor living environment. A separate housing brief is at Flag 3.

ECONOMY

The local economy has been relatively weak for decades. During most of the post-war period local unemployment rates have been twice the national average. The main reasons are:-

- run-down of the port and port-related activities.
- Over representation of low value added businesses (e.g. food processing) operating in highly competitive markets and under-representation of new technology industries.
- High proportion of manufacturing employment in large branch plants particularly vulnerable to rationalisation (e.g. British Leyland) and retrenchment during the recession.
- Manchester is the regional centre and provides strong competition for development of white collar service employment.
- Poor industrial relations image.

The economic prospects for the area remain very difficult. Many successful companies remain however, new investment is going ahead and there are examples of good co-operation between management and trade unions.

LOCAL GOVERNMENT

The proposed abolition of Merseyside Metropolitan County Council and the activities of the politically extreme Liverpool City Council are major issues. Both the County and City Councils are refusing to co-operate over abolition arrangements.

Following the making of a balanced budget in July, the City Council has continued its campaign to elicit more Government resources. There is no sign of any real attempt being made to reduce expenditure. Indeed initial bids for capital and revenue expenditure in 1985/86 are expected to be well in excess of provisional allocations and targets. Merseyside County Council is also a high spender. It is to be "rate capped" in 1985/86.

GOVERNMENT MEASURES

The thrust has been to create the right climate for investment and to improve living conditions, tackle physical dereliction and upgrade the environment. The principal measures taken by Government are:-

- Designation of Merseyside Special Development Area - considerable aid to industry over many years
- Support for local authority programmes through Rate Support Grant and other subsidies with specific grants to tackle derelict land and the Urban Programme.
- Creation of the Merseyside Development Corporation to be responsible for regenerating the derelict docklands.
- Designation of Enterprise Zone and Freeport.
- Manpower Services Commission activity aimed at improving skill levels and enhancing employment opportunities.
- Creation of the Merseyside Task Force to co-ordinate activity of Government Departments and carry through new initiatives.

The main examples of Government financial assistance to Liverpool are at Annex A and B.

MERSEYSIDE DEVELOPMENT CORPORATION

ORIGINS AND ESTABLISHMENT

The Merseyside Development Corporation was formally established in March 1981. Its prime purpose is to secure the regeneration of its area, particularly by attracting private sector investment. To this end its powers have been modelled on but are wider than those of the New Towns. In particular it has powers to acquire, reclaim, and service land and to carry out development either directly or with private developers.

AREA

MDC's designated area covers 865 acres in three separate parcels in the districts of Liverpool, Sefton and Wirral. The area consists largely of disused docks and the immediately surrounding lands, formerly used for dock-related activities. With the exception of one small housing estate in the Sefton area there is at present no resident population.

ORGANISATION AND STAFFING

MDC consists formally of a Chairman, Deputy Chairman and up to eleven other members, all appointed by the Secretary of State. The current Chairman is Sir Leslie Young, Chairman of J Bibby & Sons. He is due to become Chairman of the British Waterways Board and will leave his MDC position in October 1984. His successor will be Donald Forster, currently Chairman of Runcorn and Warrington Development Corporation.

MDC have as small permanent staff of just over 50 headed by the Chief Executive Basil Bean.

RESOURCES/EXPENDITURE

Although it is MDC's aim to attract private investment it was always envisaged that substantial public funding would be required particularly in the early years to stimulate economic activity in these severely depressed areas. Most of MDC's expenditure is supported by Government grant in aid, supplemented by loans and a limited amount of income from the leasing of land and buildings.



Expenditure in the first year of operation (1981/82) was £5m, in 1982/83 £21m and in 1983/84 £34m. This was the peak year for expenditure on the International Garden Festival (see below) and their allocation for 1984/85 is £28m.

PROGRESS

MDC have so far acquired some 600 acres of land. They are now pressing ahead with the implementation of an agreed Development Strategy. Progress in the various parts of the designated area has been varied:

In Sefton small industrial units have been built by a private developer and sites have been reclaimed and are being marketed.

In Wirral the former Western Ship Repairers site is being reclaimed for residential, light industrial and shipbuilding use. Much of the area, however, although derelict remains within the ownership of the Mersey Docks and Harbour Company and this has prevented substantial progress in reclamation and development (see below).

The Liverpool South Docks which the Prime Minister will visit, have been the focus of much of MDC's activity. By the time that MDC was established, nine years after their closure, contaminated silt up to 30 feet deep had built up throughout the system. The large historic buildings in the north had fallen into neglect and dereliction whilst further south small, under capitalised businesses provided valuable employment but failed to maintain premises which suffered from lack of services to deal with waste disposal and other needs. The land presented the most difficult engineering and accessibility problems in the urban development area but, at the northern end, provided the most exciting investment opportunities for commercial, recreational and related uses.

The Corporation's strategy for the regeneration of the South Docks includes: the restoration of the water to much of the docks system; the renewal of main services and other infra-



structure; the "opening up" of the area through new transport links; and the conversion of old buildings to new use. A major example of the last of these is the grade II listed Wapping Warehouse which lies adjacent to the newly constructed ring road. Although it does not have the same potential as Albert Dock, the Corporation feels that there is scope for successful mixed residential and commercial development. The Department has approved a £4.6m joint venture between MDC and a private developer which is expected to begin early in 1985.

Separate briefing on the four major South Docks projects; the International Garden Festival, New Enterprise Workshop, Albert Dock and Restoration of the Water Regime is at (A) - (D) below.



A. INTERNATIONAL GARDEN FESTIVAL LIVERPOOL 1984

BACKGROUND

1. The Liverpool Festival is the first of its kind to be held in this country and the biggest event in this country since the Festival of Britain in 1951.
2. The technique of staging garden festivals as a means of improving and revitalising rundown areas has been developed with great success in Europe, particularly in Germany to tackle the problems caused by wartime damage.
3. the basic purpose of a Festival is to reclaim a large piece of urban derelict land, mount a major horticultural event, and leave a permanent legacy of high quality public park and recreational area.
4. The idea was first considered in this country in 1979 when sixteen potential sites were identified. These were examined in detail and in September 1981 Michael Heseltine invited the Merseyside Development Corporation to mount the first festival.
5. The timetable allowed just over 2½ years for the reclamation, design and construction of the Festival, less than half the period usually allowed for Continental Festivals.

THE SITE

6. The site chosen for the Festival was part of a 250 acre stretch of disused and severely degraded land at Riverside on the banks of the River Mersey.
7. The site was chosen because of its proximity to the city centre and the excellent location close to the main road and rail links. The existing station at St Michaels and the airport at Speke were also considerable advantages. An important factor was the setting of the site with its fine views over the River Mersey.
8. The site included an abandoned and silted dock, disused oil storage tanks and a municipal refuse tip. The reclamation programme which began in December 1981 was one of the largest urban



reclamation schemes ever undertaken in this country.

9. Among the problems that had to be overcome were the removal of two large oil jetties, the movement of over 3 million cubic feet of material and the control and extraction of methane produced by decaying material on the former tip.

FESTIVAL CONSTRUCTION AND DESIGN

10. Once the reclamation work was substantially underway the task of constructing the actual 125 acres of the Festival began. Pre-commencement works started in October 1982 and construction began in January 1983. The co-ordination of over 200 packages of work carried out by 50 different firms was handled by the management contractors, Norwest Holst Projects Ltd.

11. Major construction works involved the movement of six and a half million tons of material on to the site and included the construction of the River Esplanade, the arena, theatres and various buildings including the Festival Hall. One and a half miles of railway had to be laid and seven miles of footpaths, walkways and aqueducts provided.

12. The design of the Festival was handled by a team of consultants led by Design Co-ordinator Rodney Beaumont of William Gillespie and Partners. Their task was to produce a design to meet the needs of both the Festival and its after uses and to incorporate the plan of all the countries and organisations who wished to be represented in the Festival.

FESTIVAL FEATURES

The Festival consists of six main elements:

- The Esplanade which ~~fulfills two~~ roles. It is a pleasant place to walk or sit and enjoy the seafront entertainments. It is also a vital link in a permanent riverside walk which will eventually extend 4½ miles from Otterspool Promenade to the Pier Head in the City Centre.



- The Water Feature design by Derek Lovejoy & Partners includes all the elements of a river; a spring source feeds a lake from where water runs through rapids and waterfalls, then through a series of meanders and terminates in a river and pool near the Festival Hall.

- National Gardens are the 37 gardens provided by UK organisations. These range from specialist horticultural gardens such as the rose, alpine and kitchen gardens to a collection of fun plots including the Jam Garden, Beatles Maze and Liverpool Quiz gardens.

- International Gardens alongside the domestic gardens are the 21 gardens reflecting the many different horticultural traditions of the participating countries. These include the British Gardens, sponsored by the Horticultural Trades Association, and the spectacular Chinese and Japanese Gardens. Other countries are providing indoor displays in the International Pavilion or the Festival Hall.

- Homes and Gardens Feature consists of a small village of houses constructed by different firms of builders in a range of styles together with a number of garden settings. After the Festival these houses will be the nucleus of a large private housing scheme planned for this section of the site.

- Exhibition Hall is the centre-piece of the Festival. Built to Arup Associates winning entry in a national design competition this hall offers 80,000 sq ft of floorspace. It is the venue for a programme of exhibitions and displays including the major indoor show programme.

BENEFITS

13. Some of the benefits of the Festival are already apparent. A major eyesore in a prominent position close to the city centre has been removed and replaced with a very high quality landscaped area in a very short time. The Festival work has also provided a stimulus to a large number of other environmental improvements throughout the City.

14. The Festival has also been a major boost to local employment. During its construction up to 600 people have been employed at any one time and a further 900 jobs will have been created directly in the operation of the Festival.

15. Except for a few specialised services that were not available locally the vast majority of contracts let for the Festival have gone to Merseyside firms and the MDC have a very good record in this respect. 96% of their contracts have gone to firms in the Merseyside region.

16. Many other jobs have been generated throughout Merseyside by the need to cater for the more than 3 million visitors to the Festival, many of them from overseas. A large number of visitors have extended their stay in the area to sample the other attractions of Merseyside. This constitutes a considerable boost to the development of the area as a tourist centre.

17. The long term benefits of the Festival will extend beyond this in generating the confidence and investment which is essential to the regeneration of Merseyside.

COSTS

18. The gross expenditure on the Garden Festival is expected to be £19.996M. [This does not include the basic reclamation works, which are estimated to cost £12.8M for the whole 250 acres of the Riverside area, of which the IGF site forms about half.⁷ The cost of construction including fees has been roughly £14M and the costs of operating the Festival will be £6M.

19. The £19.995M is offset by £1M private sponsorship (against the target of £1.5M); but the private sector is also paying for additional features, which brings the total private sector input to £2.6M. Also additional is the £1.125M spent by foreign governments on their gardens.



GOVERNMENT ROLE

20. Garden Festivals are just one of the main initiatives that have been introduced by the Government to regenerate older urban areas.

21. When Michael Heseltine, who was already aware of the success of European festivals, was appointed Secretary of State in 1979 approaches made to the Department by the British Association of Landscape Industries, supported by the Joint Council for Landscape Industries, found a ready response. Lord Bellwin met the two organisations and subsequently visited the Kassel show as part of the Department's study of garden festival experience in Europe.

22. The Department then invited urban local authorities to consider staging a festival. Sixteen sites were identified from this first approach and these were quickly sifted down to two, in Liverpool and Stoke. The Liverpool site was within the area of the MDC which was established by the Government in March 1981 to tackle the wider problems of derelict dockland on both sides of the Mersey. In the same month studies of the two sites were commissioned by the Department. The studies were completed within six months and in September 1981 Michael Heseltine invited the MDC to mount the first Festival.

23. Since then the Department has continued to take a keen interest in ensuring the success of this first festival, not least by providing the grant-in-aid support to the MDC. The Department has been represented throughout by officials on the Festival Executive Committee which has supervised all the preparations for the Festival.

VISITOR NUMBERS

It was predicted that 3 million visitors would attend the Festival; this target was in fact reached on 18th September, and the final number will be well in excess of this by the time the Festival closes on 14th October.



FUTURE FESTIVALS

The next Garden Festival will be held in Stoke on Trent in 1986. The festival is being financed jointly by the Department of the Environment and the two local authorities, City of Stoke on Trent and Staffordshire County Council.

There are three possible sites for the 1989 Festival, Gateshead, Glasgow and Swansea, currently the subject of detailed feasibility studies.



E CURRENT MDC ISSUES

FUTURE OF THE GARDEN FESTIVAL SITE

The success of the Festival has led to a surge of feeling from local people, now joined by the City and County Councils, that the Festival should be retained. This is not practical; exhibits, hired equipment etc have to be returned, there are commitments to developers, and there would be substantial costs falling on the public sector instead of receipts from the disposal of land. MDC are therefore pressing ahead, with the encouragement of the Secretary of State, in marketing to housebuilders and other developers the northern half of the site in line with the long term proposals for the area. At the same time MDC are seeking to retain flexibility in dismantling the Festival, with the objective of preserving some of the best gardens for opening to the public next summer at least, to the extent that this is compatible with meeting the demand for development.

It has always been the intention that the southern half of the site, including the Festival Hall and the arena, should be retained as a permanent public leisure and recreational facility. MDC and the then Liberal controlled City Council signed an agreement in November 1982 whereby the Council would take on responsibility for this area early in 1985, converting the Festival Hall to a sports hall. However, the present City Council have made it clear that they do not regard this as a high priority. At a meeting with MDC and DOE officials on 4 September Councillor Byrne, the Chairman of the Council's Policy and Finance Committee, stated that the Council would require extra capital and revenue allocations sufficient to meet the great majority of their own priorities in the City before they would consider taking on the Festival site. As decisions on their 1985/86, allocations will not be made before the end of the year, the City's attitude is leading to damaging uncertainty. The Secretary of State therefore issued a statement



on 6 September effectively setting the City Council a deadline of the end of the year to decide whether they would accept their portion of the Festival site. This was mis-interpreted, probably wilfully, by City Council leaders as a refusal to grant them the resources they had requested. In fact, discussions on Liverpool's allocations for next year are continuing and will be announced, along with those for all other local authorities, later in the year. /IN CONFIDENCE: It is extremely unlikely that Liverpool's allocations will be sufficient to satisfy Councillor Byrne's criterion. If Liverpool do fail to honour their commitment to take on the site, MDC could continue to maintain it in the short term while seeking private sector involvement in a leisure-oriented development7.

TATE OF THE NORTH

The Tate Gallery have proposed the establishment of a gallery in part of the Albert Dock warehouses. Discussions have taken place on possible sources of funding of this scheme. While the Tate intend to raise part of the cost from private sources, substantial public sector funding would also be required. MDC have the financial powers to contribute to a development of this nature, and they are now engaged in detailed discussions with the Tate on the options. MDC will then decide whether they wish to give financial support to the scheme, and if so, whether they accord it sufficient priority to undertake it within their existing expenditure allocations. The project will need the approval of DOE and Treasury. /IN CONFIDENCE: Informal indications are that MDC will support the project within their expenditure allocations7.

POSSIBLE EXTENSION OF THE MDC AREA

MDC's existing area is relatively small (865 acres compared to the 8 square miles of the London Docklands Development Corporation). Since MDC's designation, the operations of the Port of Liverpool have continued to contract, and there is now a substantial disused area in the Liverpool North Docks. It will be important to avoid this area falling into dereliction,



as occurred with the South Docks in the 1970s. One way of avoiding this would be to give MDC the responsibility for this area to undertake the necessary maintenance and work towards future development. Reclamation and development would almost certainly be phased over a longer period and with much lower public expenditure than in the South Docks area. The issue will shortly be the subject of a submission to DOE Ministers.

WIRRAL LAND

There is a long-running dispute between MDC and the Mersey Docks and Harbour Company over the terms on which MDC might acquire MDHC land in the Wirral part of MDC's area. This dispute has meant that MDC have made comparatively little progress there. The essence of the dispute is that MDC wish to acquire the freehold, while MDHC are prepared to grant only a leasehold interest. The two parties are now considering a proposed compromise involving land exchange.

B ALBERT DOCK WAREHOUSES

Situated at the northern end of the disused South Docks of Liverpool, the warehouses and associated buildings surrounding the Albert Dock comprise the largest collection of Grade 1 listed buildings in the country. A plan of the complex is attached. Despite their outstanding architectural merit the buildings had, until recently, lain idle and derelict for many years.

Merseyside Development Corporation purchased the Albert Dock complex from Mersey Docks and Harbour Company in May 1982. Since that time the dock basin has been dredged, removing the silt and returning the area to water, a full structural survey of the warehouses has been undertaken, and the Corporation has negotiated a joint venture with property developers (the Arrowcroft Group) to develop and market the site for new uses.

The Secretary of State for the Environment announced his approval to the project during his visit to Liverpool on 29 July 1983. The first phase consists of structural repairs, external treatment and provision of basic services undertaken by the Corporation together with refurbishment by the Arrowcroft Group of quayside/mezzanine levels for use as restaurants, boutiques, wine bars etc. Work is well advanced and, indeed, the first shop units opened for business this summer. The total cost of the first phase of the project is some £29 million.

Phase two provides for the subsequent development and marketing of the warehouses - using private sector capital and under Arrowcroft's management - for commercial and residential use. The official launching ceremony for the joint venture took place in September 1983. It is expected that total private investment in the project will be some £50 million.

Apart from the MDC/Arrowcroft venture, the northern part (Block D) of the warehouses is being developed as an extension to the County Council's Maritime Museum - this project is receiving additional support through the Urban Programme - whilst it is hoped that a "Tate in the North" art gallery will occupy part of



the western (Block C) warehouses. Granada TV are, at their own expense, currently converting the interior of the Dock Traffic Office to house an advanced news gathering centre.

It is envisaged that the Albert Dock Warehouses project will not only result in a massive environmental uplift to an outstanding conservation area and produce renewed economic activity but will provide the impetus for further private sector investment in the development of the whole South Docks area.

The Albert Dock and Mann Island areas

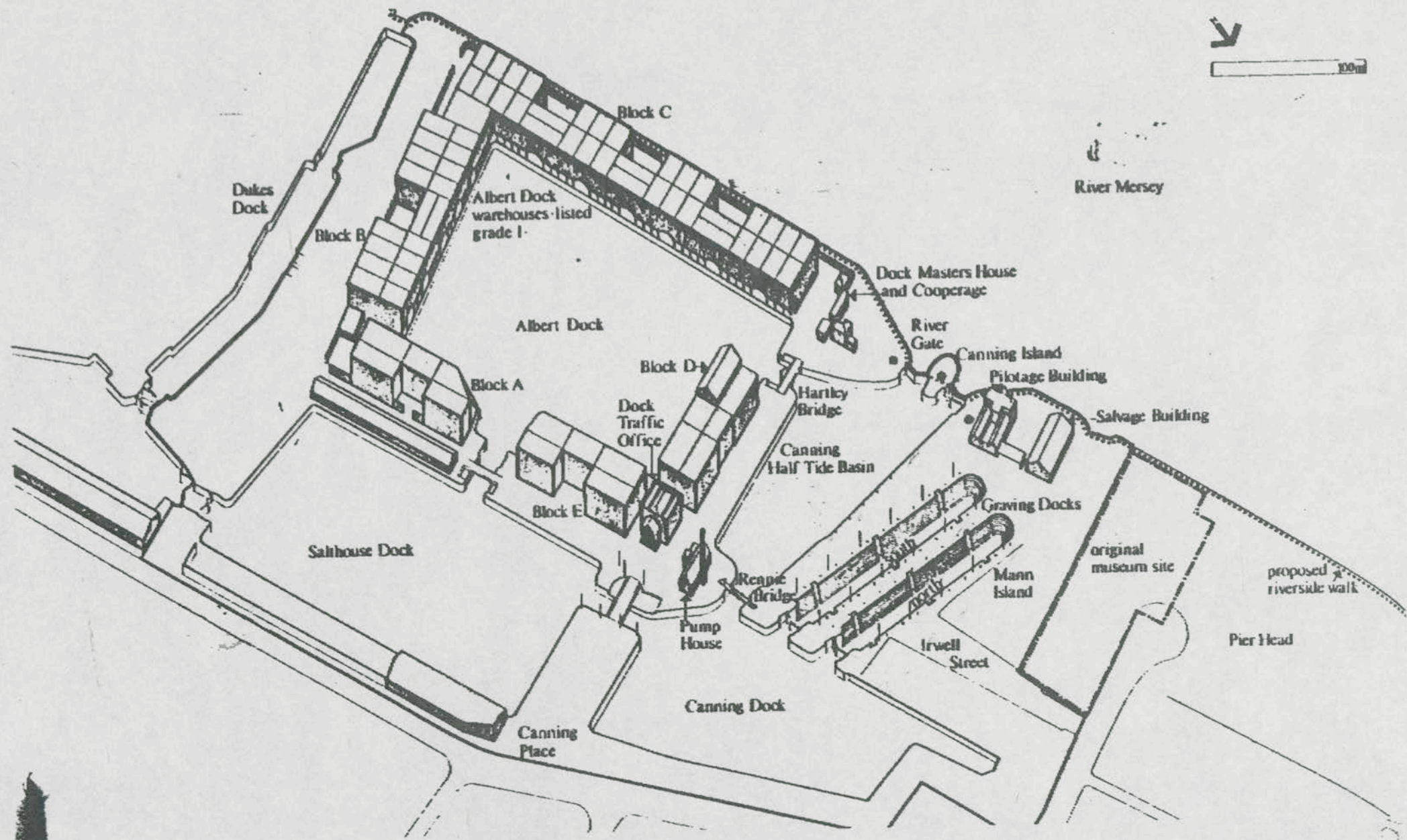



C RESTORATION OF THE WATER REGIME TO THE SOUTH DOCKS

The project to restore water to a large part of the docks system is a key element in the Corporation's strategy; it will provide an immediate and enduring improvement to the physical environment, permit water based activities and enhance the proposals for redevelopment.

The dredging of the Canning, Albert and Canning Half Tide Docks at the northern end of the system to a depth of about 18 feet (to provide a deep water regime) has been completed. The dock system from Salthouse to the south as far as Brunswick is to be dredged to about 9 feet to provide a shallow water regime, and work is well under way. The Canning river entrance gates came into operation this summer whilst construction of the Brunswick entrance will commence next year and be completed in 1987.

During the next twelve months the availability of some 65 acres of water space within seven dock basins will be marketed for water-based recreation and related marine activities which may include marinas, sailing, canoeing and wind surfing.

Restoration of a permanent water regime throughout the South Docks is expected to be completed in 1987 at a total cost of some £24 million, a less expensive exercise than the filling of these docks.

F VISIT TO INTERNATIONAL GARDEN FESTIVAL, 2 OCTOBER

1.00 Arrive Dingle Lane entrance. Walk to UK Government Pavilion via:

Gardeners Bazaar 32 chalet style shops grouped around colourful canopied area. Permanent 'shops' include official souvenirs as well as wide range of commercial units with horticultural themes or connections.

International Pavilion 350 square metres under glass for temperate, semi tropical and tropical displays. Includes exhibits from various countries including Singapore, Thailand and Australia as well as the City of Liverpool. Sponsored by Robinsons of Winchester and Pilkingtons.

INTERNATIONAL GARDENS

Holland Distinguished by glass houses and modern wind power generator. Concentrates on Dutch nursery business with close involvement of commercial interests.

Federal Republic of Germany The first international garden to be undertaken on the site. A walled garden with a brick footpath and a central pond.

Italy A formal Italian renaissance design featuring two smaller gardens and copies of fountain and temple from Rome.

Lunch in UK Government Pavilion.

Designed by Francis Machin with a landscape setting by Dame Sylvia Crowe featuring work by British sculptors. The greater part of the pavilion contains an exhibition entitled "Changing Places", the theme being the manipulation of landscape. The exhibition has been designed by Robin Wade Design Associates for the COI. The plant material within the pavilion is provided from the Royal Parks.

2.30 Walk to Fulwood Station via:

Model Forest A model forest built by the Forestry Commission at model railway scale representing an actual landscape of 7 square kilometres. Based on a section of the Dyfi Forest in North Wales, it contains over $\frac{1}{4}$ million tiny trees.

Homes and Gardens A range of houses built by leading private companies - Barratt, Broseley Homes, Norwest Holst, Wimpey and Abbey National. After the Festival closes the houses will remain and form the first phase of the residential development planned for this part of the site.



TRAIN TO FESTIVAL HALL

The Miniature Railway is a 15" gauge using engines hired from the Romney Hythe and Dymchurch railway and coaches specially built and sponsored by National Westminster Bank.

The route includes views of:

Japanese Garden A strolling landscape garden typical of the Edo Era (17th Century). Main features include hill, stream and pond representing mountains, valleys and lakes. Buildings include an 'azumaja' for resting and viewing the pond.

Chinese Garden The only Royal Garden to be constructed outside China, features replicas of two ancient imperial buildings: the Quin Quan corridor and the Zhen Buan pavilion. Main pagoda built from sections shipped over from China and constructed by Chinese workmen using traditional methods.

Indian Garden A miniature example of a Mogul Garden in three terraces with a central water feature cascading down.

Water Feature A system of water and rocks constructed to represent the various stages of a river system. Designed by Derek Lovejoy and Partners after a national competition, it is 500 metres long and holds 10,000 cubic metres of fresh water.

FESTIVAL HALL

Exhibition hall and centre-piece of the Festival. Designed by Arup Associates of London, winners of a national competition. Steel vaulted superstructure clad with translucent polycarbonate; provides 80,000 sq ft of column-free floorspace. The two half-domes of the building feature the indoor shows. The central hall is largely devoted to permanent exhibitions including:

- British Telecom. An electronic office for the Festival.
- General Motors. Sponsors of the Hall.
- Post Office. Special features including urban renewal stamps.
- MDC exhibition of plans and projects.

Walk (or train if wet) to Herculaneum exit via:

INTERNATIONAL THEME GARDENS Including

Great Britain Designed by Ray Bird winner of a design competition sponsored by the Horticultural Trades Association to 'illustrate the national character and build upon the



British garden tradition.' Over 300 different kinds of plants used in a series of inter-connecting spaces showing the variety of British gardens. Includes a gazebo giving panoramic views of the site towards the river.

Australia Represents the range of Australian scenery from arid deserts to lush coastal vegetation. Recordings of native animals are played on site.

Belgium A circular bedding area dominated by a slatted rope swing bridge.

Spain Features an olive grove bounded by a dry stone wall.

Greece A symbolic garden drawing parallels between living plants and those from mythology.

Egypt Of Pharonic design including a replica of the Temple of Isis.

NATIONAL THEME GARDENS including

Scottish Garden Miniature highland landscape including woodland and upland locks. Includes pavilion displaying Scottish crafts, tourism etc. Financial support from Scottish Development Agency and local authorities.

Victorian Garden An attempt to evoke the atmosphere of a small pleasure of the sort which evolved in the more prosperous industrial towns during late Victorian times. Sponsored by Unilever.

Rose Garden A joint effort by the Royal National Rose Society and the Rose Growers Association including more than 5,000 roses. Sponsored by the Post Office.

Granada Television A garden studio from which numerous broadcasts have been made including the Gardener's Calendar Roadshow a regular feature throughout the summer.

Heather and Conifer Garden Designed and stocked by Blooms Nurseries one of the leading commercial growers who have done much to popularise those types of plants.

'Typhoo Tug' One of the many play areas around the Festival site to accommodate the large number of younger visitors. Sponsored by Cadbury Typhoo.

3.55 Depart by car from Herculaneum entrance for Albert Dock

LUNCH AT THE INTERNATIONAL GARDEN FESTIVAL

- Sir Leslie Young Chairman of MDC until the end of October. He succeeded Sir Frank Price as Chairman of the British Waterways Board on 1 July this year. A successful Merseyside businessman, Chairman of J Bibby & Sons.
- Mr Donald Forster Will succeed Sir Leslie Young as Chairman of MDC from 1 November. Currently Chairman of Runcorn and Warrington Development Corporation, Chairman and Managing Director of the family textile firm in Leigh, Lancs.
- Lord Aberconway Commissioner General for the Festival. The Government's representative in dealings with other countries. Long-serving President of the Royal Horticultural Society.
- Basil Bean Chief Executive of MDC. Previously General Manager of Northampton New Town. Has shouldered the major organisational burden of the Festival.
- Alfred Stocks, Chief Executive Chief Executive since 1973 and immediate past-President of the Society of Local Authority Chief Executives. Joined Liverpool City in 1951, appointed Deputy Town Clerk in 1969. Wise and articulate, but in the Town Clerk tradition, not a Chief Executive.
- Sir John Clark Age 58, Chairman and Chief Executive, Plessey plc, since 1970. Educated Harrow and Cambridge. Has been associated with Plessey since 1949 and been involved with various subsidiaries within the group. Director Banque Nationale de Paris, Vice President of Institute of Work Managers and Engineering Employers Federation.
- Archbishop of Liverpool (RC) Most Reverend Derek John Harford Warlock (64). Archbishop of Liverpool since 1976. Educated St Edmunds College, Ware, Herts and ordained RC priest 1944. Private Secretary to Archbishop of Westminster 1945-64. Bishop of Portsmouth 1965-76. Member of the Synod Council 1976-77 and of the Holy See's Council and Committee for the Family from 1977-83. English delegate to the International Synod of Bishops 1974, 77, 80 and 83.
- Bishop of Liverpool Rt Reverend David Stuart Sheppard (55) Bishop of Liverpool since 1975. Educated Sherborne; Cambridge (MA) Ridley Hall Theological College. County cricketer with Sussex 1947-62 (Captain 1953). Played 22 times for England 1950-63 (Captain



1954). Warden Mayflower Family Centre Canning
Town 1957-69 Bishop Suffragan of Woolwich
1969-75.

Leonard V. Eppel
FSVA

Chairman and founder of the Arrowcroft Group.
Mr. Eppel has been a well known figure in the
property world for 30 years.

The Arrowcroft Group specialise in town centre
developments in areas of architectural sensitivity.

Barry Marsh

New Chairman of Merseyside Chamber of Commerce
and senior partner in Mace & Jones (Solicitors)
Liverpool. Specialist in industrial and
commercial law and former lecturer at Liverpool
University. Member of Solicitors Disciplinary
Tribunal.

Ray O'Brien Chief Executive Merseyside County Council and Cllr Shaw
the County Chairman were also invited to attend but we are told they
will have to decline because of Council business. Cllr Hugh Dalton,
Chairman of Liverpool City Council, has also been invited to the
lunch but it is not yet known whether he will attend.

Visit to Liverpool on 2 October 1984

Guest list for lunch at the British Pavilion,
International Garden Festival Site

1. Sir Leslie Young - Chairman, Merseyside Development Corporation
2. Lord Aberconway - Commissioner General of the IGF (the Queen's representative)
3. The Most Reverend Derek Warlock - Roman Catholic Archbishop of Liverpool
4. The Rt Reverend David Sheppard - Anglican Bishop of Liverpool
5. Donald Forster - Chairman (designate), Merseyside Development Corporation
6. Sir John Clark - Chairman, Plessey p.l.c.
Chairman, Wavertree Technology Park Company
7. Ian Pearce - Chairman, Arrowcroft (developers of Albert Dock)
8. Cllr. Ben Shaw - Chairman, Merseyside County Council
9. Cllr. Hugh Dalton - Chairman, Liverpool City Council
10. Basil Bean - Chief Executive, Merseyside Development Corporation
11. Ray O'Brien - Chief Executive, Merseyside County Council
12. Alfred Stocks - Chief Executive, Liverpool City Council
13. Basil Mansel - Chairman Merseyside Chamber of Commerce and Industry

RESTRICTED

3 OF 3

Visit to Liverpool on 2 October 1984

PROGRAMME:

- 09.30 Arrive Speke Airport
- 10.00 Arrive Grafton Crescent Housing Co-operative at start of tour of housing sites in Liverpool
- 11.10 Finish of tour at Minster Court. Depart for
- 11.25 Wavertree Technology Park
- 11.40 Speech/Open "Meet the Buyers" event
- ~~11.55 Press facility~~
- 12.10 Depart for
- 12.30 Graeme House, Derby Square (*Greet Task Force staff on arrival*)
- a. possible ³⁰(15 min) meeting with (2) representatives of the City Council
- b. ~~15/30 min. meeting with the Archbishop and Bishop of Liverpool~~
- 13.00 Depart for
- 13.30 International Garden Festival site (Dingle Lane entrance)
- Lunch at the British Pavilion (*Possible conversation with Bishop*)
- 14.30 Tour of IGF site
- 15.45 Depart for
- 16.00 Albert Dock
- ~~16.15~~ Depart for
- 16.45 Huyton Park Conservative Club (party engagement)

Local roads