

①

PRIME MINISTER

TOKYO ECONOMIC SUMMIT

We need to decide where you will stay.

The reconnaissance party have been to Tokyo. They produce strong reasons why you should stay in a hotel rather than the Ambassador's residence:

i) we can get a whole floor of the hotel, which is better for security;

ii) other delegations are in the same hotel;

iii) it is significantly nearer to the building where the Economic Summit will be held. It will, therefore, save driving and holding up the traffic.

To which I would add:

iv) the Ambassador has to cope with the Prince and Princess of Wales two days after you leave Tokyo.

Agree to stay in hotel?

C.D.P.

Yes

C.D. Powell
6 March 1986



file

PA

10 DOWNING STREET

From the Private Secretary

7 March 1986

TOKYO ECONOMIC SUMMIT

You wrote about accommodation in Tokyo for the Economic Summit. The Prime Minister has agreed to stay in the hotel proposed rather than at the Ambassador's residence. The proposed room allocation enclosed with your letter is acceptable.

(Charles Powell)

Len Appleyard, Esq., CMG,
Foreign and Commonwealth Office.

Jo

000
CONFIDENTIAL

CCPC
MS/IB



Foreign and Commonwealth Office

London SW1A 2AH

6 March 1986

Dear Charles,

Economic Summit, Tokyo: Accommodation

As a result of their recent visit to Tokyo, the reconnaissance party have recommended that the Prime Minister, Secretary of State and Chancellor of the Exchequer should all stay in the New Otani Tower Block Hotel. We have just heard that if the Prime Minister does stay in the hotel, the room requested on the 37th floor will be available (diagram attached). The rest of the Delegation would also be in the hotel.

The Prime Minister could of course stay in the Ambassador's Residence. This would, however, mean that she could be accompanied only by Sir Geoffrey Howe (plus a Private Secretary and detective each), with the Chancellor and the rest of the Delegation in the New Otani Hotel. Another drawback is that there would be only a very small room available for the No 10 Private Office.

On the security aspects, our reconnaissance party received a detailed briefing from the Japanese police and security officials. It was clear that the depth and detailed application of the Japanese preparatory work, together with the search procedures and protective measures in force, will ensure safe conditions at the Summit site. In view of the road movement problems, were the Prime Minister and another Minister to stay in the Ambassador's Residence, we recommend that the Prime Minister and entire UK Delegation stay in the New Otani Hotel. Detective Superintendent Waller, the Prime Minister's senior detective, agrees.

I should be grateful to know the Prime Minister's wishes.

CONFIDENTIAL



CONFIDENTIAL

I am copying this letter to Rachel Lomax (HM Treasury) and to Michael Stark (Cabinet Office).

Yours ever,

Lee Appleyard

(L V Appleyard)
Private Secretary

C D Powell Esq
10 Downing Street

CONFIDENTIAL

37th floor

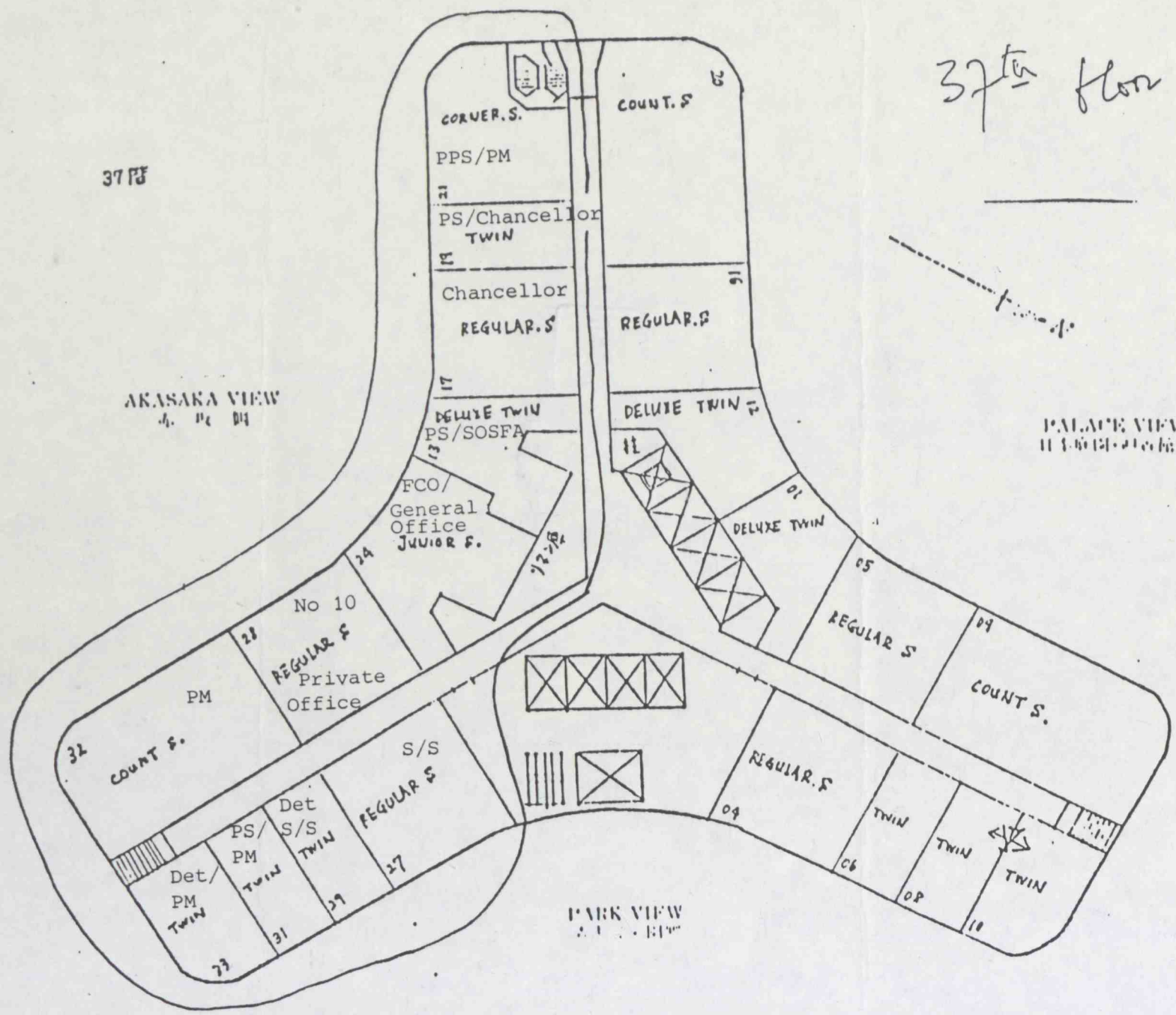

37th

AKASAKA VIEW
A. 14 014

PALACE VIEW
11 16 12 21 16 15

PARK VIEW
A. 14 014

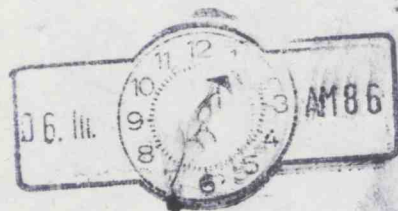



FROM: S M Waghorn (Miss)
DATE: 1 May 1986
cc : Superintendent Waller

Private Secretary

1. There is a wash room for the Prime Minister on the second floor of the Akasaka Palace, room number 224.

S M Waghorn

S M Waghorn (Miss)
Conference Officer